

EXPAND & UPGRADE

OPTION 1

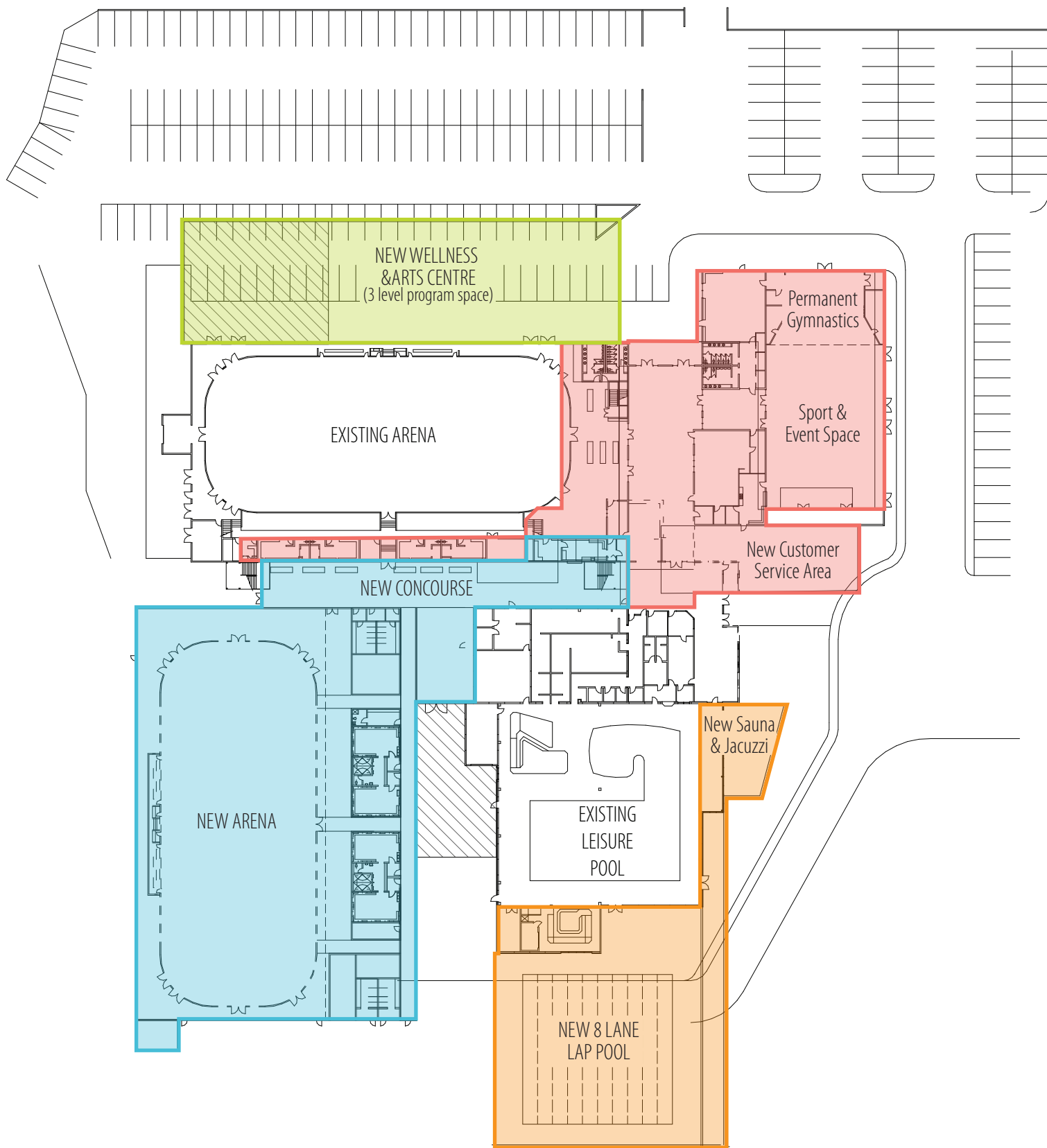

SECOND ICE ARENA PHASE
(\$23m)

WELLNESS & ARTS CENTRE PHASE
(\$11m)

UPGRADE TO EXISTING FACILITIES PHASE
(\$9.5m)

NEW 8-LANE LAP POOL PHASE
(\$15m)

FEATURES

- Improved east façade – better first impression
- Improved front entry weather protection
- Improved foyer, lobbies, new elevator
- Consolidated customer service/administration area
- Auditorium converted to functional sports gymnasium
- Permanent gymnastics space added
- Portable stage added
- Updated existing arena change rooms, washrooms and mezzanine
- Updated and expanded concession
- Second ice arena: ice sheet, change rooms, washrooms, storage areas, viewing stands
- New Wellness & Arts Centre: rehabilitation/fitness area, program space for arts and recreation, youth space, washrooms, change rooms
- Undeveloped shell space (in upper floors) for future expansion or leasable partnership or commercial space
- New 8-lane lap pool: viewing gallery, jacuzzi, steam room and sauna
- New phases and upgraded areas would be fully accessible

CONSIDERATIONS

- Easy to phase development over time
- Minimal disruption to existing facility
- Will continue to meet life and safety standards based on building codes of the day (Aquatic Centre 25 years old and Arena 40 years old). New sections will be built to present-day code
- No tree removal
- Minimal impact on parking
- Existing ice slab was updated in 2017 so no further upgrade to the slab is contemplated
- Existing leisure pool and change rooms re-tiled in 2017-20; no further upgrades contemplated in this option

TOTAL SIZE	17,000 m²
TOTAL ESTIMATED COST <small>(IF COMPLETED IN 2020)</small>	\$55,000,000
TOTAL ESTIMATED COST <small>(IF COMPLETED IN PHASES 2020-2028)</small>	\$58,500,000
POTENTIAL FOR FUTURE PHASING IN 2030	Additional 3,500 m² with approximate cost of \$25m