

# EXPAND & UPGRADE

## OPTION 2

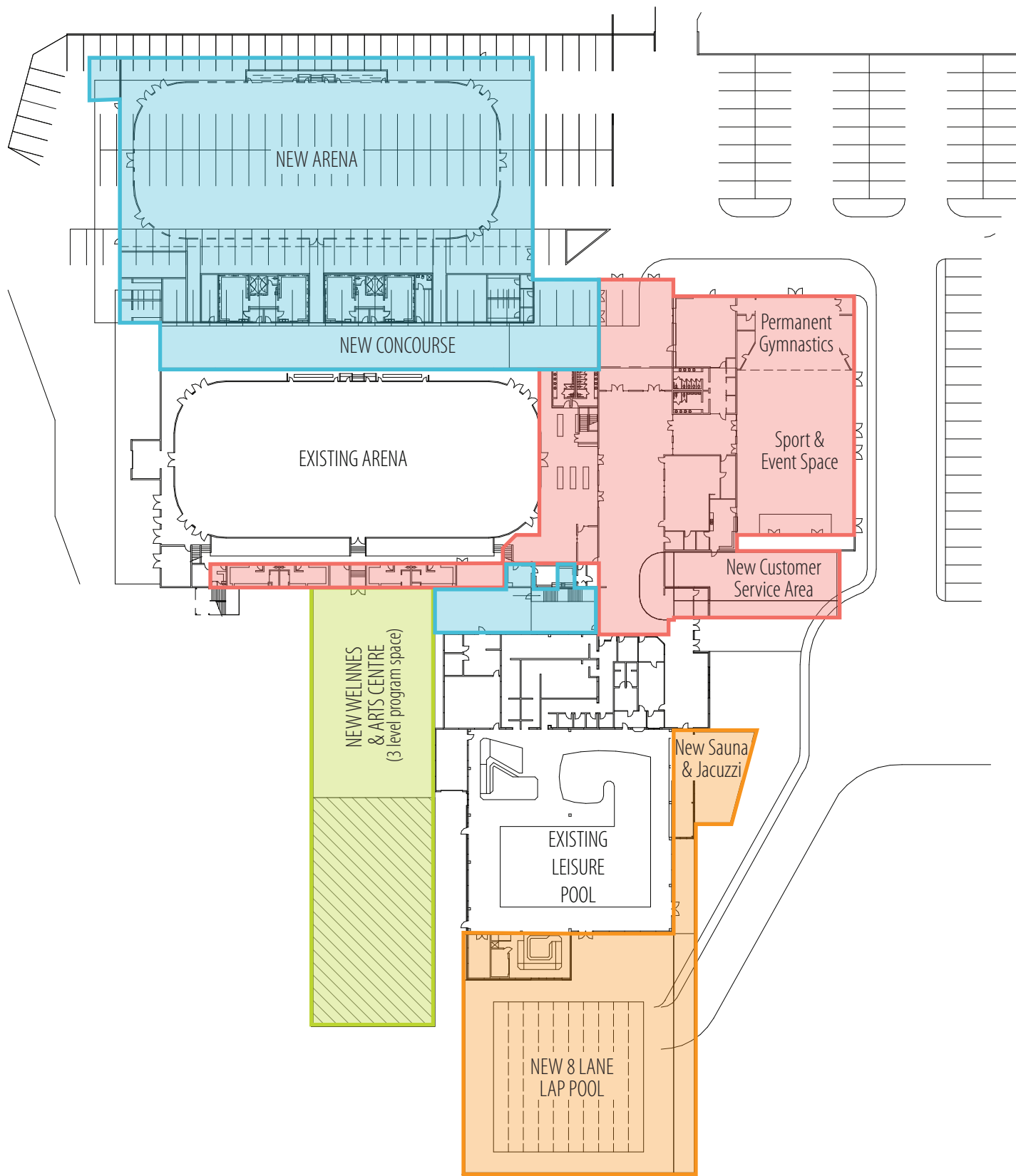

**SECOND ICE ARENA PHASE**  
(\$23m)

**WELLNESS & ARTS CENTRE PHASE**  
(\$11m)

**UPGRADE TO EXISTING FACILITIES PHASE**  
(\$9.5m)

**NEW 8-LANE LAP POOL PHASE**  
(\$15m)

### FEATURES

Same features as Option 1, but building is configured differently - second ice arena and Wellness/Arts Centre are switched:

- Improved east façade – better first impression
- Improved front entry weather protection
- Improved foyer, lobbies, new elevator
- Consolidated customer service/administration area
- Auditorium converted to functional sports gymnasium
- Permanent gymnastics space added
- Portable stage added
- Updated existing arena change rooms, washrooms and mezzanine
- Updated and expanded concession
- Second ice arena: ice sheet, change rooms, washrooms, storage areas, viewing stands
- New Wellness & Arts Centre: rehabilitation/fitness area, program space for arts and recreation, youth space, washrooms, change rooms
- Undeveloped shell space (in upper floors) for future expansion or leasable partnership or commercial space
- New 8-lane lap pool: viewing gallery, jacuzzi, steam room and sauna
- New phases and upgraded areas would be fully accessible

### CONSIDERATIONS

- Impacts current parking. Requires parking to be reduced or relocated to current greenspace

Remainder of considerations are the same as Option 1:

- Easy to phase development over time
- Minimal disruption to existing facility
- Will continue to meet life and safety standards based on building codes of the day (Aquatic Centre 25 years old and Arena 40 years old). New sections will be built to present-day code
- Existing ice slab was updated in 2017 so no further upgrade to the slab is contemplated
- Existing leisure pool and change rooms re-tiled in 2017-20; no further upgrades contemplated in this option

<b>TOTAL SIZE</b>	<b>17,000 m<sup>2</sup></b>
<b>TOTAL ESTIMATED COST</b> (IF COMPLETED IN 2020)	<b>\$55,000,000</b>
<b>TOTAL ESTIMATED COST</b> (IF COMPLETED IN PHASES 2020-2028)	<b>\$58,500,000</b>
<b>POTENTIAL FOR FUTURE PHASING IN 2030</b>	<b>Additional 3,500 m<sup>2</sup> with approximate cost of \$25m</b>