

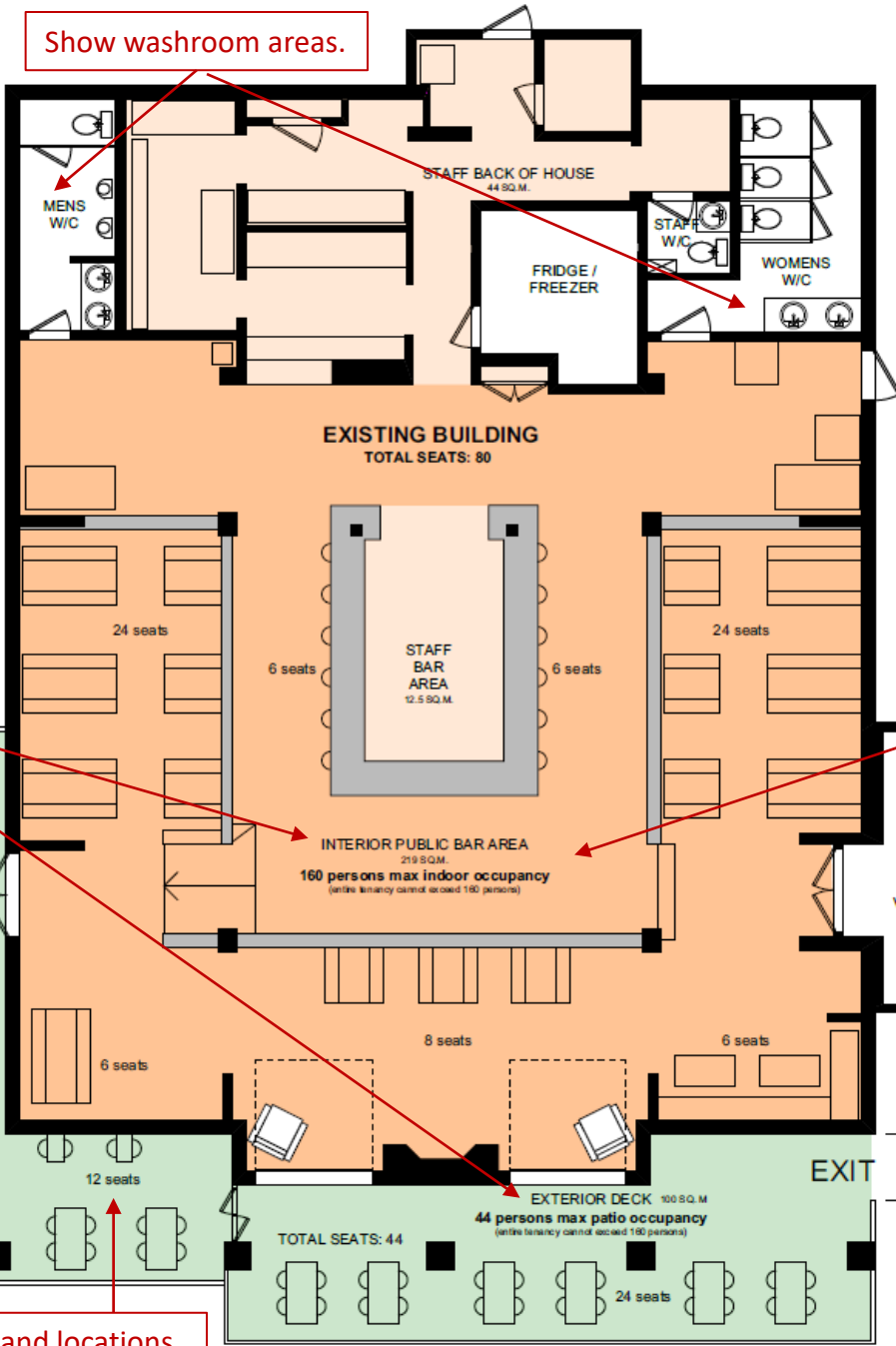

Plans with occupancies exceeding 30 persons must be stamped by an Architect.

Show washroom areas.



Clearly indicate the difference between patio area and interior area. The use of text and colour is recommended.

Provide exit widths and exit capacities.

Show seating counts and locations

OCCUPANT LOAD:
160 persons including the patio

Include TOTAL occupancy Load in clear bold letters on the plan. Ensure it includes "with patio".

Show how occupancy is being calculated and difference of patio vs. interior occupancy. This can be a table or written in text on the plan.

1907 MAPLE DRIVE - 'BACKYARD'
OCCUPANT LOAD CALCULATION - BASED ON BCBC 2018

3.1.17 OCCUPANT LOAD

	AREA	LOCATION		
PUBLIC	219M ²	INTERIOR PUBLIC BAR AREA (EXCLUDES WASHROOMS) - FIXED SEATING & STANDING SPACE	3 MALE & 3 FEMALE, PERMITS 150 MAX. PERSONS AS PER 3.7.2.2.	GLOBAL OCCUPANT LOAD
	13M ²	VESTIBULE - NOT INTENDED TO FORM PART OF OCCUPANCY LOAD	MAX. FOR PATIO IS 44 PERSONS	
	100M ²	EXTERIOR DECK - FIXED SEATING (REFER TO WASHROOM COUNT)		150 PUBLIC
STAFF	44M ²	STAFF BACK OF HOUSE (EXCLUDES FRIDGE / FREEZER & WASHROOM) - REFER TO WASHROOM COUNT FOR MAX. OCCUPANT LOAD	1 STAFF WASHROOM PERMITS 10 STAFF AS PER 3.7.2.2.(4)	10 STAFF
	12.5M ²	STAFF BAR AREA - MAX. STAFF LOAD AS NOTED ABOVE		TOTAL 160 PERSONS

THE OCCUPANT LOAD IS LESS THAN THAT NOTED IN TABLE 3.1.17.1 THEREFORE A PERMANENT SIGN SHALL BE POSTED IN A CONSPICUOUS LOCATION

NOTES:
- THIS CALCULATION DOES NOT INCLUDE A REVIEW OF THE ZONING BYLAW, PARKING BYLAW & ANY OTHER CODE OR LIFE-SAFETY ASPECTS APART FROM WHAT IS NECESSARY FOR OCCUPANT LOAD CALCULATION
EXIT WIDTH SHOULD COMPLY WITH BCBC 3.4.3.2, & ACCESSIBILITY REQUIREMENTS SHOULD COMPLY WITH BCBC SECTION 3.8, BOTH CONFIRMED & VERIFIED BY THE DISTRICT OF SQUAMISH.

PROPOSED NEW PATIO
SCALE: 1' = 1/8"